

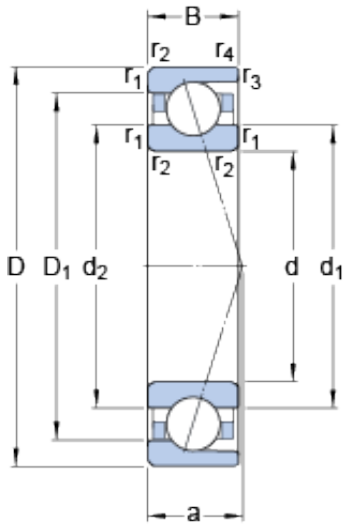

NTN BEARING-BOWER CORP.



7021 ACD/HCP4A Bearing 2D drawings and 3D CAD models

105 mm x 160 mm x 26 mm SKF 7021
ACD/HCP4A angular contact ball bearings

Bearing No. 7021 ACD/HCP4A

Size	160x105x26 mm
Bore Diameter	160 mm
Outer Diameter	105 mm
Width	26 mm
d	105 mm
D	160 mm
B	26 mm
d ₁	121.9 mm
d ₂	121.9 mm
D ₁	143.1 mm
r _{1,2} - min.	2 mm
r _{3,4} - min.	1 mm
a	44 mm
d _a - min.	114 mm
d _b - min.	114 mm
D _a - max.	151 mm
D _b - max.	155 mm
r _a - max.	2 mm
r _b - max.	1 mm
d _n	125.6 mm
Basic dynamic load rating - C	90.4 kN
Basic static load rating - C ₀	93 kN
Fatigue load limit - P _u	3.4 kN
Limiting speed for grease	9000 r/min



NTN BEARING-BOWER CORP.

Lubrication	
Limiting speed for oil lubrication	14000 mm/min
Ball - D_w	17.462 mm
Ball - z	21
G_{ref}	20.4 cm ³
Calculation factor - e	0.68
Calculation factor - Y_2	0.87
Calculation factor - Y_0	0.38
Calculation factor - X_2	0.41
Calculation factor - Y_1	0.92
Calculation factor - Y_2	1.41
Calculation factor - Y_0	0.76
Calculation factor - X_2	0.67
Preload class A - G_A	560 N
Preload class B - G_B	1120 N
Preload class C - G_C	2240 N
Preload class D - G_D	4480 N
Calculation factor - f	1.15
Calculation factor - f_1	0.99
Calculation factor - f_{2A}	1
Calculation factor - f_{2B}	1.02
Calculation factor - f_{2C}	1.05
Calculation factor - f_{2D}	1.08
Calculation factor - f_{HC}	1.02
Preload class A	309 N/micron
Preload class B	405 N/micron
Preload class C	537 N/micron
Preload class D	727 N/micron



NTN BEARING-BOWER CORP.

d_1	121.9 mm
d_2	121.9 mm
D_1	143.1 mm
$r_{1,2}$ min.	2 mm
$r_{3,4}$ min.	1 mm
d_a min.	114 mm
d_b min.	114 mm
D_a max.	151 mm
D_b max.	155 mm
r_a max.	2 mm
r_b max.	1 mm
d_n	125.6 mm
Basic dynamic load rating C	90.4 kN
Basic static load rating C_0	93 kN
Fatigue load limit P_u	3.4 kN
Attainable speed for grease lubrication	9000 r/min
Attainable speed for oil-air lubrication	14000 r/min
Ball diameter D_w	17.462 mm
Number of balls z	21
Reference grease quantity G_{ref}	20.4 cm ³
Preload class A G_A	560 N
Static axial stiffness, preload class A	309 N/ μ m
Preload class B G_B	1120 N
Static axial stiffness, preload class B	405 N/ μ m
Preload class C G_C	2240 N
Static axial stiffness, preload class C	537 N/ μ m
Preload class D G_D	4480 N
Static axial stiffness, preload class D	727 N/ μ m



NTN BEARING-BOWER CORP.

class D	
Calculation factor f	1.15
Calculation factor f_1	0.99
Calculation factor f_{2A}	1
Calculation factor f_{2B}	1.02
Calculation factor f_{2C}	1.05
Calculation factor f_{2D}	1.08
Calculation factor f_{HC}	1.02
Calculation factor e	0.68
Calculation factor (single, tandem) Y_2	0.87
Calculation factor (single, tandem) Y_0	0.38
Calculation factor (single, tandem) X_2	0.41
Calculation factor (back-to-back, face-to-face) Y_1	0.92
Calculation factor (back-to-back, face-to-face) Y_2	1.41
Calculation factor (back-to-back, face-to-face) Y_0	0.76
Calculation factor (back-to-back, face-to-face) X_2	0.67
Mass bearing	1.32 kg